



WN1000RP WiFi Booster for Mobile Installation Guide



Contents

- Getting Started. 3
- Meet Your WiFi Booster. 4
 - Front Panel and Side Panel 4
 - Bottom Panel. 4
 - LED Descriptions. 5
 - Button Descriptions 6
- Install the WiFi Booster 7
 - Place the WiFi Booster 7
 - Connect the WiFi Booster 7
- Access WiFi Booster Settings 16
- Frequently Asked Questions 17

Getting Started

The NETGEAR WiFi Booster for Mobile increases the distance of a WiFi network by boosting the existing WiFi signal and enhancing the overall signal quality over long distances. A WiFi booster repeats the signals from an existing WiFi router or access point.

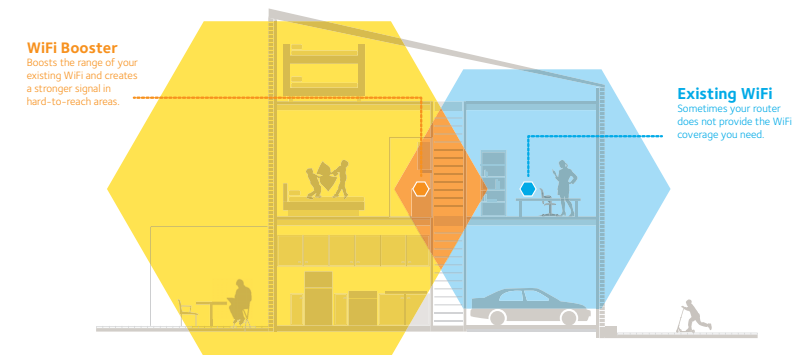

Meet Your WiFi Booster

Before you install your WiFi booster, familiarize yourself with its LEDs and buttons.

Front Panel and Side Panel

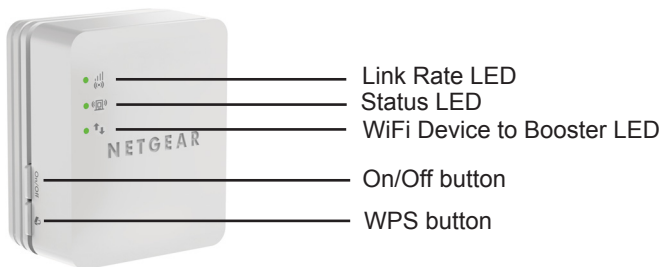

Bottom Panel

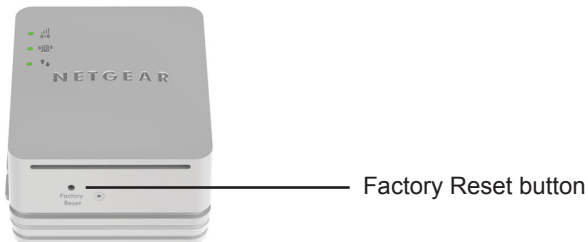

LED Descriptions

Use the LEDs during installation to find the best location for the WiFi booster or to monitor the WiFi booster performance.

Link Rate LED



This LED indicates a wireless connection between the WiFi booster and the router.

- **Solid green.** Best connection.
- **Solid amber.** Good connection.
- **Solid red.** Poor connection.
- **Off.** No connection

Status LED



This LED is lit when the WiFi booster is powered on.

WiFi Device to Booster LED



This LED is lit when the WiFi booster is connected to a computer or mobile device.

Button Descriptions

The side panel has the following features:

- **On/Off button.** Turns the device on and off.
- **WPS button.** Press the WPS button to wirelessly connect the WiFi booster to your router. All LEDs blink when the WPS connection starts.

The bottom panel has the Factory Reset button. To use this button, insert a paper clip into the reset hole and hold it until the Status LED blinks. Then wait for the booster to reboot.

Install the WiFi Booster

Place the WiFi booster, apply power, and connect it to your WiFi network.

Place the WiFi Booster

1. Place your WiFi booster in the same room as your WiFi router.
Note: Proximity to the WiFi router is required only during the initial setup process.
2. Plug the WiFi booster into an electrical outlet and wait one minute. The Status LED ●  lights green. If the Status LED does not light, press the **On/Off** button.

Connect the WiFi Booster

To extend the range of your WiFi network, you must connect the WiFi booster to your existing WiFi network. You can do this in one of two ways:

- **Connect with WPS.** For more information, see *Connect with WPS* on page 8.
- **Connect with genie Smart Setup.** For more information, see *Connect with NETGEAR genie Smart Setup* on page 10.

Connect with WPS

Wi-Fi Protected Setup (WPS) lets you join a secure WiFi network without typing the network name and password. The **WPS** button is a physical button on the router or access point.

WPS does not support WEP network security. If you are using WEP security, see *Connect with NETGEAR genie Smart Setup* on page 10.

➤ To connect with WPS:

1. Press the **WPS** button  on the WiFi booster.
2. Within two minutes, press the **WPS** button on your WiFi router, gateway, or access point.

The Link Rate LED  on your WiFi booster lights, and the WiFi booster is connected to your existing WiFi network.

Note: If the Link Rate LED does not light, try again. If it still does not light, see *Connect with NETGEAR genie Smart Setup* on page 10.

3. Find the new WiFi booster network name.

The WiFi booster's network name (SSID) changes to your existing WiFi network name, with _EXT at the end of the name.

For example:

- **Existing WiFi network name.** MyNetworkName
- **New extended network name.** MyNetworkName_EXT

4. Connect your existing WiFi devices to the new extended network (MyNetworkName_EXT).

Use the same WiFi password that you use for your WiFi router.

5. Unplug the WiFi booster and move it to a new location closer to the area with a poor WiFi signal.

The location you choose must be within the range of your existing WiFi router network.

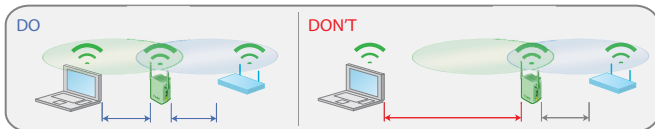

6. Plug the WiFi booster into an electrical outlet and wait one minute.

The Status LED ● (📶) lights green. If the Status LED does not light, press the **On/Off** button.

Use the Link Rate LED on the front panel to help you choose a spot where the WiFi booster-to-router connection is optimal.

Connect with NETGEAR genie Smart Setup

1. Use a WiFi network utility on a computer or mobile device to find and connect to the NETGEAR_EXT (SSID) WiFi network.

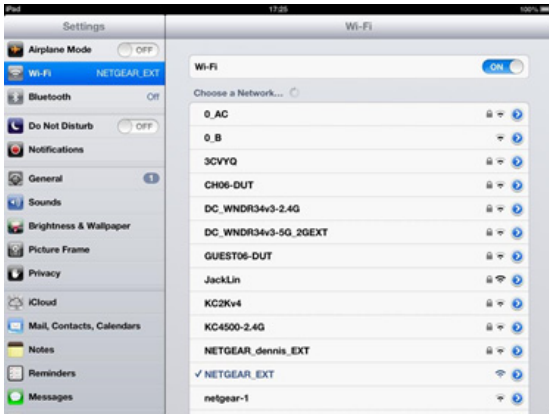

After the connection with the computer or mobile device is established, the WiFi Device to Booster LED  turns green.

2. Open a web browser window from the same computer or mobile device.

The browser takes you directly to the NETGEAR genie® Smart Setup.

Note: If you are not automatically directed to NETGEAR genie, launch an Internet browser and type **www.mywifiext.net** in the address field of the browser. Enter **admin** for the user name and **password** for the password.

3. Select an existing WiFi network to extend and click the **Continue** button.

NETGEAR genie™
WN1000RP

Extender-to-Router
Device-to-Extender
Apply Settings

Select the name of your existing network.

Refresh Continue

	SSID	Channel	Signal	Security
<input type="radio"/>	lulu	1	100%	WPA2-PSK
<input type="radio"/>	B(o)(o)(o)M	4	100%	WPA2-PSK
<input type="radio"/>	lulu	1	100%	WPA2-PSK
<input type="radio"/>	NETGEAR-WNDR4500	6	100%	WPA2-PSK
<input type="radio"/>	php	6	100%	WPA/WPA2-PSK
<input type="radio"/>	NETGEAR33	9	100%	WPA2-PSK
<input type="radio"/>	WNDR4500v2_Team	11	100%	WPA2-PSK
<input checked="" type="radio"/>	D6300_2_4Main	11	100%	WPA/WPA2-PSK

4. Type the network passphrase (also called password or security key) in the **PassPhrase** field and click the **Continue** button.

The screenshot shows the Netgear genie WN1000RP web interface. On the left, there is a sidebar with three buttons: "Extender-to-Router" (highlighted in blue), "Device-to-Extender", and "Apply Settings". The main content area has a heading "Enter the security settings of the selected WiFi network." Below this, it says "Your existing network in 2.4GHz:". There are three fields: "Name (SSID):" with the value "D6300_2.4Main", "Security:" with the value "WPA-PSK - WPA2-PSK", and "PassPhrase:" with an empty text box. At the bottom of the main area are two buttons: "Back" and "Continue".

5. Type the name (SSID) for your WiFi booster network in the **2.4GHz Network Name (SSID)** field and click the **Continue** button.

Note: You can use the same security settings as your existing network by selecting the check box.

The screenshot shows the Netgear genie WN1000RP web interface. On the left, there is a sidebar with three buttons: "Extender-to-Router", "Device-to-Extender" (highlighted in blue), and "Apply Settings". The main content area has a heading "Enter the settings for the Extender network." Below this, there is a "Continue" button. There is a field "2.4GHz Network Name (SSID):" with the value "D6300_2.4Main_EXT". Below this field is a checkbox that is checked, with the text "Use the same security mode and password as those for the existing network." At the bottom of the main area is a horizontal line.

The WiFi booster settings are applied and the following screen displays:

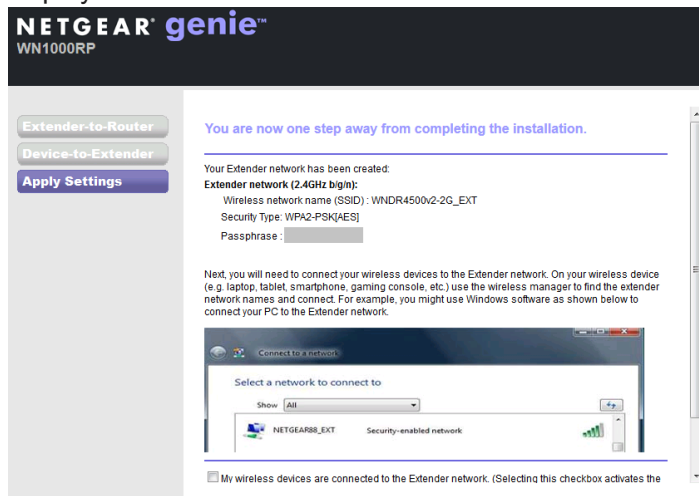

6. Use a WiFi network manager on the computer or mobile device to connect to the WiFi booster's newly created WiFi network. Repeat this step for all of your computers and mobile devices.

7. Select the check box and click the **Continue** button.

NETGEAR **genie™**
WN1000RP

Extender-to-Router

Device-to-Extender

Apply Settings

You are now one step away from completing the installation.

Your Extender network has been created:

Extender network (2.4GHz b/g/n):

Wireless network name (SSID) : D6300_2.4Main_EXT

Security Type: WPA/WPA2-PSK

Passphrase :

Next, you will need to connect your wireless devices to the Extender network. On your wireless device (e.g. laptop, tablet, smartphone, gaming console, etc.) use the wireless manager to find the extender network names and connect. For example, you might use Windows software as shown below to connect your PC to the Extender network.



☒ My wireless devices are connected to the Extender network. (Selecting this checkbox activates the Continue button.)

Continue

8. Unplug the WiFi booster and move it to a new location closer to the area with a poor WiFi signal.

The location you choose must be within the range of your existing WiFi router network.

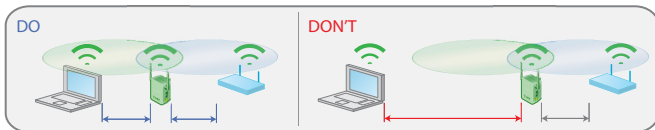

9. Plug the WiFi booster into an electrical outlet and wait one minute. The Status LED ● (📶) lights green. If the Status LED does not light, press the **On/Off** button.

Use the Link Rate LED on the front panel to help you choose a spot where the WiFi booster-to-router connection is optimal.

Access WiFi Booster Settings

After installation, you can log in to the WiFi booster to view or change the WiFi booster's settings.

- **To log in to the WiFi booster after the initial set up:**
1. Connect a computer or mobile device to the WiFi booster's network.
 2. Launch an Internet browser.
 3. Type **www.mywifiext.net** or **www.mywifiext.com** in the address field of the browser.
A login screen displays.
 4. Enter **admin** for the user name and **password** for the password.

Frequently Asked Questions

You can find more information about your product in the user manual, which is available at <http://support.netgear.com>.

The web browser setup guide keeps asking me for my network security key (passphrase), and I am sure I have entered the correct passphrase. What can I do?

The WiFi booster is probably placed at the borderline of the range covered by the router. For more information, see *Place the WiFi Booster* on page 7.

If you are using WEP security, make sure that you are typing the wireless key in the correct field.

I am connected to NETGEAR_EXT and launched a browser. Why can't I see the NETGEAR genie Smart Setup?

Try these troubleshooting steps:

- Make sure that your computer is set up to use DHCP (most are).
- Make sure the WiFi Device to Booster status LED is green and you have a valid IP address.
- Relaunch the web browser and type **www.mywifiext.net** or **www.mywifiext.com** in the address field of the web browser. Enter **admin** for the user name and **password** for the password.

What are the user name and password to log in to the WiFi booster?

The user name is **admin** and the default password is **password**. Both are case-sensitive.

I have enabled a wireless MAC filter (wireless access control - ACL) on my router. What should I do when installing the WiFi booster?

When the wireless device connects through the WiFi booster to your router, the MAC address of the wireless device shown on the router is translated to another MAC address. If your router's MAC filter is enabled, the wireless device connects to the WiFi booster but cannot get an IP address from the WiFi booster and cannot access the Internet. To allow the wireless device to receive an IP address from the WiFi booster and access the Internet, you must provide the translated MAC address to the router.

➤ To get the translated MAC address:

- 1.** Disable the MAC filter on your router.
- 2.** Power on the WiFi booster and connect all of your wireless devices to the WiFi booster.

3. Make sure that the Link Rate LED remains lit.
4. Log in to your router and check the attached devices on the Attached Devices screen.
5. Add any MAC addresses that begin with **02:0F:B5** to your router's MAC filter table.

Attached Devices

Wired Devices

#	IP Address	Device Name	MAC Address
1	192.168.1.7	SQA-PERF-PC	D48E D98A B590

Wireless Devices (Wireless intruders also show up here)

#	IP Address	Device Name	MAC Address
1	192.168.1.8	optiplex-936c99	020F B5 C4 7C C8
2	192.168.1.10	sqa-dell_5300	020F B5 28 31 20
3	192.168.1.250	WN2500RP	020F B5 3C 59 E3
4	--	--	E0 24 B2 3C 59 E4
5	192.168.1.10	sqa-dell_5300	020F B5 28 31 20
6	--	--	E2 24 B2 3C 59 E4

Refresh

Support

Thank you for selecting NETGEAR products. After installing your device, locate the serial number on the label of your product and use it to register your product at <https://my.netgear.com>.

You must register your product before you can use NETGEAR telephone support. NETGEAR recommends registering your product through the NETGEAR website.

For product updates and web support, visit <http://support.netgear.com>.

NETGEAR recommends that you use only the official NETGEAR support resources. You can get the user manual online at <http://downloadcenter.netgear.com> or through a link in the product's user interface.

Trademarks

NETGEAR, the NETGEAR logo, and Connect with Innovation are trademarks and/or registered trademarks of NETGEAR, Inc. and/or its subsidiaries in the United States and/or other countries. Information is subject to change without notice. © NETGEAR, Inc. All rights reserved.

Compliance

For the current EU Declaration of Conformity, visit http://support.netgear.com/app/answers/detail/a_id/11621/.

For regulatory compliance information, visit <http://www.netgear.com/about/regulatory/>.

NETGEAR, Inc.

350 East Plumeria Drive
San Jose, CA 95134 USA



201-14549-06

November 2013